

FLOAT & THERMOSTATIC IN-LINE STEAM TRAPS

MATERIALS

Part	Description
Head	Cast Iron, ASTM-A278 Class 30
Body	Cast Iron, ASTM-A278 Class 30
Bolting	Steel, Grade 5
Gaskets	Compressed Graphite
Float	Stainless Steel
Plug	Stainless Steel
Seat	Stainless Steel



CAPACITIES (Gross)
Lbs. condensate per hour

Pipe Size	Model No.	Pressure Differential (PSIG)														
		1/4	1/2	1	2	5	10	15	20	25	30	40	50	75	100	125
1/2"	FTI-2015-2	293	387	513	683	824	1050	1129	-	-	-	-	-	-	-	-
3/4"	FTI-2015-3	293	387	513	683	824	1050	1129	-	-	-	-	-	-	-	-
1"	FTI-2015-4	293	387	513	683	824	1050	1129	-	-	-	-	-	-	-	-
1 1/4"	FTI-2015-5	630	808	1029	1302	1722	2100	2457	-	-	-	-	-	-	-	-
1 1/2"	FTI-2015-6	1155	1785	2520	3465	5250	6930	7980	-	-	-	-	-	-	-	-
2"	FTI-2015-8	2415	2940	3780	4883	7245	9450	11445	-	-	-	-	-	-	-	-
1/2"	FTI-2030-2	293	387	513	683	824	1050	1129	1271	1375	1439	-	-	-	-	-
3/4"	FTI-2030-3	293	387	513	683	824	1050	1129	1271	1375	1439	-	-	-	-	-
1"	FTI-2030-4	293	387	513	683	824	1050	1129	1271	1375	1439	-	-	-	-	-
1 1/4"	FTI-2030-5	394	525	725	956	1260	1575	1764	1890	1995	2100	-	-	-	-	-
1 1/2"	FTI-2030-6	1050	1365	1785	2415	3570	4830	5775	6300	6930	7350	-	-	-	-	-
2"	FTI-2030-8	1365	1890	2625	3570	5460	7140	8190	9030	9765	10500	-	-	-	-	-
1/2"	FTI-2075-2	168	224	294	383	546	735	835	919	977	1019	1176	1292	1523	-	-
3/4"	FTI-2075-3	168	224	294	383	546	735	835	919	977	1019	1176	1292	1523	-	-
1"	FTI-2075-4	168	224	294	383	546	735	835	919	977	1019	1176	1292	1523	-	-
1 1/4"	FTI-2075-5	410	578	667	956	1397	1943	2258	2520	2730	2940	3203	3465	3990	-	-
1 1/2"	FTI-2075-6	557	761	1008	1365	1995	2783	3203	3570	3885	4200	4620	4988	5670	-	-
2"	FTI-2075-8	893	1155	1575	2100	3255	4358	4987	5460	5775	6090	6720	7140	8085	-	-
1/2"	FTI-2125-2	105	142	184	242	347	436	525	593	651	698	788	872	1019	1166	1249
3/4"	FTI-2125-3	105	142	184	242	347	436	525	593	651	698	788	872	1019	1166	1249
1"	FTI-2125-4	105	142	184	242	347	436	525	593	651	698	788	872	1019	1166	1249
1 1/4"	FTI-2125-5	294	389	504	662	956	1260	1523	1733	1864	1995	2179	2363	2783	3098	3308
1 1/2"	FTI-2125-6	420	546	714	935	1365	1785	2153	2415	2625	2835	3150	3360	3990	4410	4725
2"	FTI-2125-2	578	709	924	1286	2048	2730	3150	3413	3675	3990	4410	4850	5775	6430	6930

Note on Capacity: Trap capacities are based on continuous discharge at steam temperature. The published figures are the result of an extensive testing program Conducted in accordance with ANSI/ASME PTC 39.1-1980, Condensate Removal Device for Steam Systems, at the Barnes and Jones factory. Significantly greater capacities Are realized when condensate temperature is below saturated steam temperature. A safety factor between 2-4 should be applied to these ratings.

NOTE: FLOAT TRAPS are available for those applications where draining liquids is the only requirement of the trap. In those instances the thermostatic air vent is replaced by a solid plug. To order, use the previous model number with the prefix "FI" instead of "FTI". All pipe sizes and pressure ratings are available.

DIMENSIONS

Size	Models	A	B	C	WT.
1/2"-1"	FTI-2015	5"	6.25"	6.5"	11#
1/2"-1"	FTI-2030	5"	6.25"	6.5"	11#
1/2"-1"	FTI-2075	5"	6.25"	6.5"	11#
1/2"-1"	FTI-2125	5"	6.25"	6.5"	11#
1 1/4"	FTI-2015	5"	6.25"	6.5"	11#
1 1/4"	FTI-2030	5"	6.25"	6.5"	11#

FTI

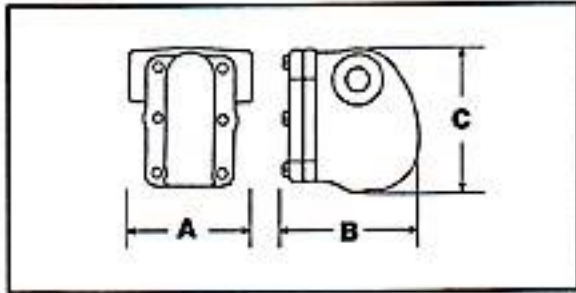

DIMENSIONS

Size	Models	A	B	C	WT.
1 1/4"	FTI-2075	7.5"	10.5"	11.5"	48#
1 1/4"	FTI-2125	7.5"	10.5"	11.5"	48#
1/2-2"	FTI-2015	7.5"	10.5"	11.5"	47#
1/2-2"	FTI-2030	7.5"	10.5"	11.5"	47#
1/2-2"	FTI-2075	7.5"	10.5"	11.5"	47#
1/2-2"	FTI-2125	7.5"	10.5"	11.5"	47#

FTI

